



MICRON INTELLIGENT COMPUTERIZED HEIGHT GAUGE

USER MANUAL





MICRON FORCE COMPUTERIZED HEIGHT GAUGE

Item No	Range	Resolution	Accuracy	Force control	Base	Functions	Data output		Calibration
							USB	Wireless	
	mm	mm	mm				USB	Wireless	ISO 17025
1443030261	0-300	0,001	±0,020	12N	Cast iron	Error & Temp	+	max 50 m	+
1443050261	0-500	0,001	±0,030	12N	Cast iron	comp. Preset.	+	max 50 m	+
1443100261	0-1000	0,001	±0,040	12N	Cast iron	Memory	+	max 50 m	+
1443150261	0-1500	0,001	±0,060	12N	Cast iron	Max/Min	+	max 50 m	+
1443200261	0-2000	0,001	±0,075	12N	Cast iron	Limits	+	max 50 m	+

MICRON FORCE WHEEL COMPUTERIZED HEIGHT GAUGE

Item No	Range	Resolution	Accuracy	Fine adjust. wheel with Force	Functions	Data output		Calibration
						USB	Wireless	
	mm	mm	mm			USB	Wireless	ISO 17025
1443030263	0-300	0,001	±0,020	8N	Error & Temp comp. Preset.	+	max 50 m	+
1443050263	0-500	0,001	±0,030	8N	Memory	+	max 50 m	+
1443060263	0-600	0,001	±0,030	8N	Max/Min Limits	+	max 50 m	+

MICRON COMPUTERIZED HEIGHT GAUGE (GRANITE BASE)

Item No	Range	Resolution	Accuracy	Fine adjust. wheel with Force	Functions	Data output		Calibration
						USB	Wireless	
	mm	mm	mm			USB	Wireless	ISO 17025
1443030266	0-300	0,001	±0,015	8N	Error & Temp comp. Preset.	+	max 50 m	+
1443050266	0-500	0,001	±0,025	8N	Memory	+	max 50 m	+
1443060266	0-600	0,001	±0,025	8N	Max/Min Limits	+	max 50 m	+

Clean the oil from the measuring surfaces of height gauge by cloth.

For recharging caliper (Li-Pol rechargeable battery) connect it with standard USB cable to charger device.

DO NOT LEAVE UNCHARGED CALIPER FOR A LONG TIME.

THIS MAY RESULT TO INTERNAL BATTERY FAILURE!

Turn on caliper by pressing ON button (1 sec).

For zero setting use Force control module- line inside lens must be came off with outside line. Press the **ZERO** button (2 sec) on Touchscreen for ZERO position setting.

For save measuring data to internal caliper's memory touch data area on screen or short button push. You can view saved data throw menu or send throw USB or Wireless connection to Windows PC, Android or iOS devices.

All functions of caliper you can see on p.5 of instruction or in demo video on www.microtech.ua

www.microtech.ua

MAIN INFO



MICROTECH

- SWITCH ON DEVICE** - button push (1 sec)
- SWITCH OFF DEVICE** - auto switch off (configuring throw DISPLAY SETTING menu)
- button push (3 sec)
- ZERO SETTING** - 0 button in Touchscreen display (2 sec)



Parameters	
LED display	1,5 inch
Power supply	Rechargeable Li-Pol battery
Lifetime	>80h (Medium brightness)
Charging port	micro-USB
Measuring force	8N
Wireless data transfer	15m/ 50m with external antenna (from set)

CHARGING

For charging connect USB cable



Charging process indicating on Battery status (switch on device)

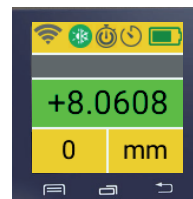

BUILT-IN BATTERY - rechargeable Li-Pol battery

VIDEO INSTRUCTION





MENU NAVIGATION

functions status

Battery status

color indication Go/NoGo

mm/inch conversion

ZERO setting

MAIN MENU

Folders	001
001	+0.0020
002	+1.5509
+ New Folder	+11.0781

MEMORY MANAGER
folders system
transferring data from memory to PC

< +00.0001

> +00.0001

MIN

LIMITS
color Go/NoGo

Max/Min

Enable

MAX

MAX/MIN
indicating max or min value

A +00.0000

B +00.0000

C +00.0000

RESET

FORMULA MODE
 Ax^2+Bx+C

Timer

+000 sec.

RESET

TIMER MODE
saving or transfer data on timer

01.0000

OK

RESET

ERROR COMPENSATION
mathematical correction

Temp. comp.

None Mode

+25.00 C

TEMPERATURE COMPENSATION
manual correction 4 materials

Resolution

X.0000

RESOLUTION
selected up to 0.0001mm

Extra

Axis Mode

Normal

AXIS MODE
normal or inverted

Wireless Trans

Normal

1 min

WIRELESS
modes of data transmission

Mode OFF

UART OFF

Keypad ON

CONFG

USB
USB connection configuration

Device

Auto start ON

PIN RESET

DEVICE SETTING
autostart, reset, password

Angle

Sleep

Light High

SCREEN SETTING
screen rotation, brightness

Mode

Folders

+000

RESET

MEMORY SETTING
folder configuration

Link to software

SOFTWARE
link to download app

Calibration Date

DAY MONTH YEAR

01 01 2020

CHANGE

CALIBRATION STATUS
calibration date control

app@microtech.ua

F411RE

FW: 1.1.1

MAC: 00000

ID: 00000000

DEVICE INFO
service info about device



USB CONNECTION



USB-DONGLE



UP TO 50M

WIRELESS CONNECTION

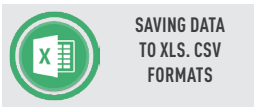
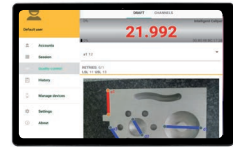
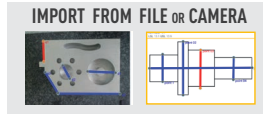

SAVING DATA TO XLS, CSV FORMATS

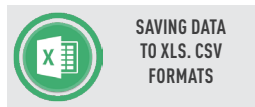

SAVING DATA TO XLS, CSV FORMATS



SAVING DATA TO XLS, CSV FORMATS

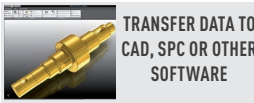

TRANSFER DATA TO CAD, SPC OR OTHER SOFTWARE



SAVING GRAPH



SAVING GRAPH



TRANSFER DATA TO EXCEL OR OTHER TABLE EDITORS



VOICE MODE



VOICE MODE

DATA TRANSFER DISTANCE FOR INTELLIGENT INSTRUMENTS

- All MICROTECH Intelligent instruments has internal memory. You can collect data to memory and when it will be necessary transfer all data to the peripheral device with no data losing.
- It's possible transfer data, like in Wireless instruments up to 15 m or up 50 m with external antenna
- USB port can be used to transfer data directly to Windows PC



QUALITY CONTROL RESULTS



LIMITS GO/NOGO

MENU SETTING

< +00.0001
> +00.0001
MIN

MAIN SCREEN

+8.0608
0 mm
NoGo Go NoGo

MAX - NoGo over MAX value
MIN - NoGo over MIN value
RANGE - selecting GO range
NONE - No active mode

FORMULA

A +00.0000
B +00.0000
C +00.0000
RESET

EXAMPLES:
- for value x2 - B=2
- set PRESET 100mm C=100
- square value A=1

Avialable Formulas:
- Ax^2+Bx+C
-Radius (for indicators)
-Sphere (for indicators)

MATH. ERROR COMPENSATION

0.010000 Red value
0.010000 Green value
OK
RESET

- actual value on instrument
- compensated value

Use up&down button to update actual value (green) to correct value.
For compensation correction - push OK.
After points correction computerized instrument will recalculate values according corrected points

RESOLUTION

Resolution
X.0000 +8.0608

Selecting instrument resolution

MAX/MIN

Max/Min
Enable
MAX

Status indication on main screen

+8.0608
0 mm

ENABLE/DISABLE mode indicating MAX dvalue indicating MIN value

TIMER

Timer
+000 sec.
RESET

Timer indication on main screen

+8.0608
0 mm

Saving or transfer data by Timer
Select timer period
For disactive - reset to zero

TEMPERATURE COMPENSATION

Temp. comp.
Glass, Quartz
Solid alloys, Mo
+25.00

+8.0608
0 mm

Re-calculation value to calibration conditions 20C
7 types of materilas for selection
Manual temperature setting

EXTRA (Axis mode)

Extra
Axis Mode
Normal

+/- value indication

+8.0608
0 mm

Selecting normal or inverted axis mode

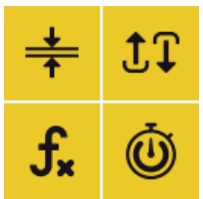

FUNCTIONS



MICROTECH

WIRELESS CONNECTION

Wireless Trans

Normal

1 min

WIRELESS status

+8.0608

0 mm

USB CONNECTION

Mode OFF

UART OFF

Keypad ON

CONFIG

Windows

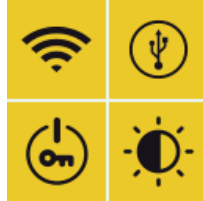

PIN

Device

Auto start ON

PIN RESET

DISPLAY SETTING

Angle 0

Sleep off

Rotation 0, 90, 180, 270

Sleep mode

Brightness level

+8.0608

0 mm

8090'8+

MEMORY MANAGER SETTINGS

Mode	001
Folder	+0.0020
+000	+1.5509
RESET	+11.0781

- Standard / Folder mode

In Folder mode possible to set qty values in each folder.

LINK TO SOFTWARE

Link to software

Free Software for Windows, Android, iOS

Link to page with MDS Software download

- for Android, iOS, Windows
- Free and Pro versions

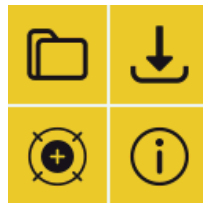

CALIBRATION DATE

Calibration Date

DAY	MONTH	YEAR
01	01	2020

CHANGE

Saving or transfer data by Timer

Select timer period

For disactive - reset to zero

DEVICE INFO

app@microtech.ua

F411RE

FW: 1.1.1

MAC: 00000

ID: 00000000

Information about firmware version and MAC adress for easy connection



MICROTECH

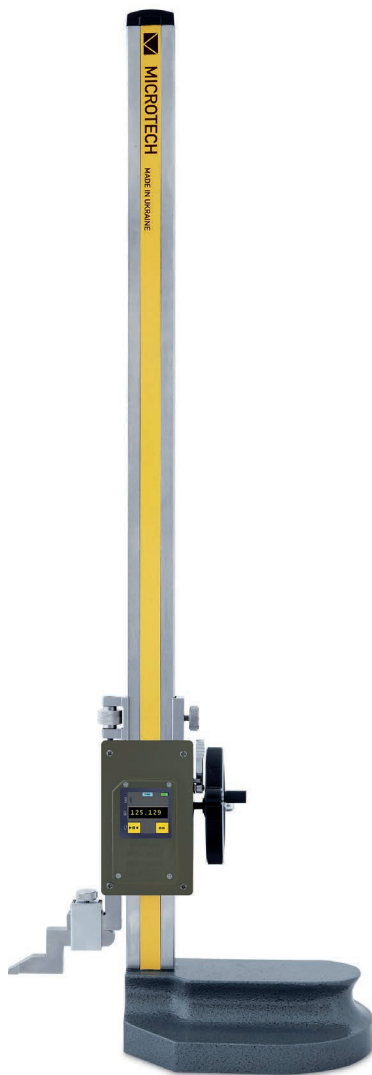

MICROTECH

innovative measuring instruments

61001, Kharkiv, Ukraine, str. Rustaveli, 39

tel.: +38 (057) 739-03-50

www.microtech.ua

tool@microtech.ua

Change without prior notice

Edition: M1030_0520